

**SEALEY****Power  
TOOLS**

INSTRUCTIONS FOR:

# AIR ANGLE DRILL 10mm REVERSIBLE

MODEL No: **SA26.V3**

Thank you for purchasing a Sealey Product. Manufactured to a high standard this product will, if used according to these instructions and properly maintained, give you years of trouble free performance.



**IMPORTANT: PLEASE READ THESE INSTRUCTIONS CAREFULLY. NOTE THE SAFE OPERATIONAL REQUIREMENTS, WARNINGS AND CAUTIONS. USE THIS PRODUCT CORRECTLY AND WITH CARE FOR THE PURPOSE FOR WHICH IT IS INTENDED. FAILURE TO DO SO MAY CAUSE DAMAGE AND/OR PERSONAL INJURY AND WILL INVALIDATE THE WARRANTY. PLEASE KEEP INSTRUCTIONS SAFE FOR FUTURE USE.**

## 1. SAFETY INSTRUCTIONS

- WARNING!** Ensure Health & Safety, local authority, and general workshop practice regulations are adhered to when using this equipment.
- WARNING!** Disconnect from air supply before changing drill bits, servicing, or performing any maintenance.
- ✓ Maintain the drill in good condition (use an authorised service agent).
- ✓ Replace or repair damaged parts. *Use genuine parts only. Unauthorised parts may be dangerous and will invalidate the warranty.*
- ✓ Use in a suitable work area. Keep area free from unrelated materials and ensure that there is adequate lighting.
- ✓ Before each use check condition of drill bit. Sharpen if necessary. If worn or damaged, replace immediately.
- ✓ Ensure the speed rating (rpm) of the drill bit is the same as, or greater than, the speed rating of the drill.
- ✓ Ensure there are no flammable or combustible materials near the work area.
- ✓ Evaluate your working area before using the drill. Ceilings, floors and enclosures may contain hidden electrical wiring, water pipes or gas pipes.
- WARNING!** Always wear approved eye (or face) and hand protection when operating the drill.
- ✓ Use face, dust, or respiratory protection in accordance with COSHH regulations.
- ✓ Depending on the task, the drilling noise level may exceed 84dB in which case wear safety ear defenders.
- ✓ Remove ill fitting clothing. Remove ties, watches, rings, other loose jewellery and contain and/or tie back long hair.
- ✓ Wear appropriate protective clothing and keep hands and body clear of working parts.
- ✓ Maintain correct balance and footing. **DO NOT** over reach, ensure the floor is not slippery, wear non-slip shoes.
- ✓ Keep children and unauthorised persons away from the working area.
- ✓ Check moving parts alignment on a regular basis.
- ✓ Ensure workpiece is secure before operating the drill. **DO NOT** hold a workpiece by hand.
- ✓ Check the workpiece to ensure there are no protruding screws, bolts, nuts etc.
- ✓ Avoid unintentional starting.
- ✓ Remove chuck key before starting the drill.
- WARNING!** Ensure correct air pressure is maintained and not exceeded. Recommended pressure 70-90psi
- ✓ Keep air hose away from heat, oil and sharp edges. Check air hose for wear before each use and ensure that all connections are secure.
- ✓ Prolonged exposure to vibration from this drill poses a health risk. It is the owner's responsibility to correctly assess the potential hazard and issue guidelines for safe periods of use and offer suitable protective equipment.
- x **DO NOT** use the drill for a task it is not designed to perform.
- x **DO NOT** operate drill if any parts are damaged or missing as this may cause failure and/or personal injury.
- WARNING! DO NOT** drill any materials containing asbestos.
- x **DO NOT** carry the drill by the hose, or yank the hose from the air supply.
- x **DO NOT** force, or apply heavy pressure to the drill; let the tool do the work.
- x **DO NOT** place air line attachments close to your face and **DO NOT** point at other people or animals.
- x **DO NOT** operate drill when you are tired, under the influence of alcohol, drugs or intoxicating medication.
- x **DO NOT** use drill where there are flammable liquids, solids or gases such as paint solvents and including waste wiping or cleaning rags etc.
- x **DO NOT** carry the drill with your hand on the trigger.
- ✓ When not in use disconnect from air supply and store in a safe, dry, childproof location.

## 2. INTRODUCTION & SPECIFICATION

Right angle air drill with 90° planetary gearbox. Ideal for drilling in hard to get at areas where normal drills will not fit. Push-button reverse feature suitable for driving fixings. Supplied with 10mm chuck and key.

Free Speed ..... 1500rpm  
Operating Pressure ..... 90psi  
Air Consumption ..... 13.5cfm  
Air Inlet ..... 1/4" BSP

Weight ..... 1.1kg  
Chuck Size ..... Ø10mm  
Noise Power ..... 100.7dB.A  
Noise Pressure ..... 89.7dB.A

## 3. PREPARING DRILL FOR USE

### 3.1. Air Supply

**WARNING!** Ensure the air supply is clean and does not exceed 90psi while operating the drill. Too high an air pressure and unclean air will cause excessive wear, and may be dangerous, causing damage and/or personal injury.

- 3.1.1. Ensure the drill air valve (or trigger) is not depressed before connecting to the air supply.
- 3.1.2. You will require an air pressure between 70-90psi, and an air flow according to the specification above.
- 3.1.3. Drain the air tank daily. Water in the air line will damage the drill and invalidate your warranty.
- 3.1.4. Clean air inlet filter weekly. Recommended hook-up procedure is shown in fig 1.
- 3.1.5. Line pressure should be increased to compensate for unusually long air hoses (over 8 metres). The minimum hose diameter should be 1/4" internal diameter and fittings must have compatible dimensions.
- 3.1.6. Keep hose away from heat, oil and sharp edges. Check hoses for wear, and make certain that all connections are secure.

### 3.2. Air Couplings

Vibration may cause failure if a quick change coupling is connected directly to the air drill. To overcome this, connect a leader hose - Sealey model number AH2R - to the drill. A quick change coupling may then be used to connect the leader hose to the air line hose. See fig.1 & fig.2.

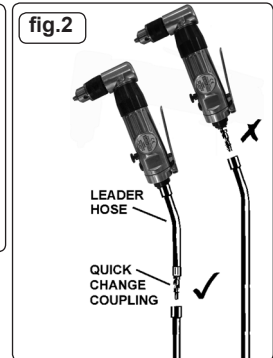
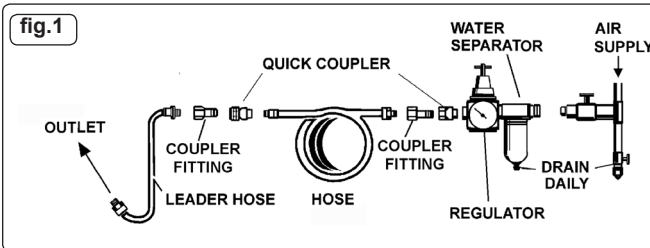

## 4. OPERATING INSTRUCTIONS

**WARNING!** Ensure you read, understand and apply safety instructions before use.

### 4.1. Fitting Drill Bit.

- 4.1.1. Regularly check the drill bit and always change if worn, cracked or otherwise damaged.
- WARNING! Disconnect drill from the air supply before placing drill bit into chuck.**
- 4.1.2. Open or close the chuck jaws to a point where the opening is slightly larger than the drill or tool bit (fig.3.A) to be used. Also raise the front of the drill slightly to prevent drill bit from falling out of the chuck jaws. Insert the drill bit into the chuck as far as it will go. Place the chuck key in one of the chuck holes and tighten the chuck securely.

**WARNING! Ensure the chuck key is removed before starting the drill.**

### 4.2. Connection to Air Supply.

**Note!** Squeeze the trigger to check that the drill is working correctly before starting work.

- 4.2.1. **DO NOT** allow drill to run freely for an extended period of time as this will reduce bearing life.

### 4.3. Changing Direction of Rotation.

- 4.3.1. The change over button is located on the opposite side of the drill body from the trigger (fig.4).
- 4.3.2. To change the direction of rotation of the chuck, disconnect the drill from the air supply, push the change over button inwards and rotate clockwise until it locks into place (fig.5).

4.3.3. Rotate the button counter-clockwise to release the change over button and switch the direction of rotation again.

#### 4.4. Standard Drilling Instructions.

**WARNING! Ensure you wear approved safety goggles and any other safety item required for the job. Remove the chuck key before using the drill. Ensure that all other safety requirements are followed.**

4.4.1. Connect drill to air supply.

4.4.2. Hold tool firmly and place the drill bit tip to the point to be drilled.

4.4.3. Depress the trigger to start drill. Move the drill bit into the work piece applying only enough pressure to keep the bit cutting. **DO NOT** force or apply side pressure to elongate the hole.

4.4.4. If the material to be drilled is free standing it should be secured in a vice or with clamps to keep it from turning as the drill bit rotates.

4.4.5. When drilling metals, use a light oil on the drill bit to keep it from overheating. Oil will prolong drill bit life and improve the drilling action.

4.4.6. For hard smooth surfaces use a centre punch to mark desired hole location. This will prevent the drill bit from slipping as drilling commences.

4.4.7. A pilot hole may be necessary to assist the final drill size through the work piece. Lock a pilot drill (smaller size drill than the finished hole size) into the chuck. Follow steps 4.4.1. to 4.4.3. above and drill a pilot hole in the middle of the centre punch mark where final hole is to be drilled. Insert the final sized drill bit in chuck. Hold drill firmly and place the bit at the entrance of the pilot hole and depress the trigger.

**WARNING! Be prepared for drill bit binding on break through. When these situations occur the drill has a tendency to grab and kick in the opposite direction which could cause loss of control. If you are not prepared, this loss of control can result in damage and/or personal injury.**

4.4.8. If the drill bit jams in the work piece or if the drill stalls, release the trigger switch immediately. Remove the drill bit from the work piece and determine the reason for jamming.

## 5. MAINTENANCE

**WARNING! Disconnect drill from air supply before changing drill bit, servicing or performing maintenance.** Replace or repair damaged parts. *Use genuine parts only. Unauthorised parts may be dangerous and will invalidate the warranty.*

5.1. Lubricate the drill daily with a few drops of good grade air tool oil, such as Sealey ATO/500 or ATO/1000, dripped into the air inlet before use or dispensed automatically through an air system oiler, such as Sealey model number SA106L.

5.2. Clean the drill after use and change the drill bit when worn or damaged.

5.3. Loss of power or erratic action may be due to the following:

a) Excessive drain on the air supply. Moisture or restriction in the air line. Incorrect size or type of hose connectors. To remedy check the air supply and follow instructions in Section 3.

b) Grit or gum deposits in the drill may also reduce performance. Flush the drill with gum solvent oil or an equal mixture of SAE No.10 oil and kerosene. Allow to dry before use.

If you experience problems, contact your local Sealey service agent.

5.4. For a full service contact your local Sealey service agent.

5.5. When not in use, disconnect from air supply, clean drill and store in a safe, dry, childproof location.

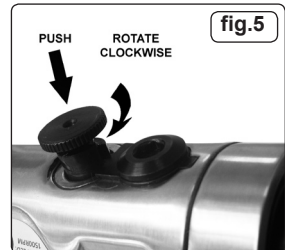
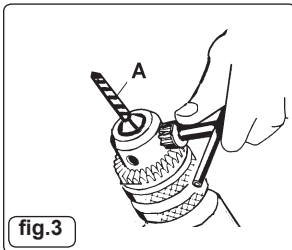





# EC DECLARATION OF CONFORMITY

We the sole importers into the UK, hereby declare that the equipment described below

Description and Function: **Air Angle Drill 10mm Reversible**

Model/Type: **SA26.V3**

Manufacturing Date / Serial number (optional):

Manufacturer's authorised representative within the EC: **Jack Sealey Ltd. Kempson Way, Suffolk Business Park, Bury St. Edmunds, Suffolk, IP32 7AR**

Conforms to the requirements of the following Directives, as indicated.

- 2006/42/EC Machinery Directive
- 2000/14/EC Outdoor Noise Emissions Directive
- 2006/95/EC Low Voltage Directive
- 2002/96/EC WEEE Directive
- 2004/108/EC EMC Directive
- 2002/95/EC RoHS Directive
- 93/68/EEC CE Marking Directive
- 97/23/EC Pressure Equipment Directive
- 2009/105/EC the Simple Pressure Vessels Directive

**And the following harmonised standard(s)**

**BS EN 792 part 3: 2000 + A1: 2008**

**BS EN 28662 part 1: 1993**

.....  
.....

Additional technical standards and specifications (if applicable):

.....

Technical file compiled by: **Jack Sealey Ltd.**

Signed: 

Date: 29-Jun-2012

Place: Bury St.Edmunds.

Name: Mark Sweetman

Position: Managing Director



**Being the responsible person appointed by the manufacturer.**

Sealey Power Products, Kempson Way,  
Suffolk Business Park, Bury St. Edmunds,  
Suffolk, IP32 7AR

 01284 757500

 01284 703534

 sales@sealey.co.uk

 www.sealey.co.uk