

Thank you for purchasing a Sealey product. Manufactured to a high standard this product will, if used according to these instructions and properly maintained, give you years of trouble free performance.

**IMPORTANT: PLEASE READ THESE INSTRUCTIONS CAREFULLY. NOTE THE SAFE OPERATIONAL REQUIREMENTS, WARNINGS & CAUTIONS. USE THE PRODUCT CORRECTLY AND WITH CARE FOR THE PURPOSE FOR WHICH IT IS INTENDED. FAILURE TO DO SO MAY CAUSE DAMAGE AND/OR PERSONAL INJURY AND WILL INVALIDATE THE WARRANTY. PLEASE KEEP INSTRUCTIONS SAFE FOR FUTURE USE.**

## 1. SAFETY INSTRUCTIONS

- 1.1. ELECTRICAL SAFETY.  WARNING! It is the user's responsibility to read, understand and comply with the following:** You must check all electrical equipment and appliances to ensure they are safe before using. You must inspect power supply leads, plugs and all electrical connections for wear and damage. You must ensure the risk of electric shock is minimised by the installation of appropriate safety devices. An RCCB (Residual Current Breaker) should be incorporated in the main distribution board. We also recommend that an RCD (Residual Current Device) is used with all electrical products. It is particularly important to use an RCD with portable products that are plugged into an electrical supply not protected by an RCCB. If in doubt consult a qualified electrician. You may obtain a Residual Current Device by contacting your Sealey dealer. You must also read and understand the following instructions concerning electrical safety.
- 1.1.1. **The Electricity At Work Act 1989** requires all portable electrical appliances, if used on business premises, to be tested by a qualified electrician, using a Portable Appliance Tester (PAT), at least once a year.
- 1.1.2. The **Health & Safety at Work Act 1974** makes owners of electrical appliances responsible for the safe condition of the appliance and the safety of the appliance operator. **If in any doubt about electrical safety, contact a qualified electrician.**
- 1.1.3. Ensure the insulation on all cables and the product itself is safe before connecting to the mains power supply. See 1.1.1. & 1.1.2. above and use a Portable Appliance Tester (PAT).
- 1.1.4. Ensure that cables are always protected against short circuit and overload.
- 1.1.5. Regularly inspect power supply, leads, plugs for wear and damage and all electrical connections to ensure that none is loose.
- 1.1.6. **Important:** Ensure the voltage marked on the product is the same as the electrical power supply to be used, and check that plugs are fitted with the correct capacity fuse. A 13 amp plug may require a fuse smaller than 13 amps for certain products, see fuse rating below.
- 1.1.7. DO NOT pull or carry the appliance by its power supply lead.
- 1.1.8. DO NOT pull power plug from socket by the power cable.
- 1.1.9. DO NOT use worn or damaged leads, plugs or connections. Immediately replace or have repaired by a qualified electrician. A U.K. 3 pin plug with ASTA/BS approval is fitted. In case of damage, cut off and fit a new plug according to the following instructions (discard old plug safely). (UK only - see diagram below). **Ensure the unit is correctly earthed via a three-pin plug.**
- a) **Connect the green/yellow earth wire to the earth terminal 'E'.**
- b) **Connect the brown live wire to live terminal 'L'.**
- c) **Connect the blue neutral wire to the neutral terminal 'N'.**
- d) **After wiring, check that there are no bare wires, that all wires have been correctly connected, that the cable outer insulation extends beyond the cable restraint and that the restraint is tight.** Double insulated products are fitted with live (BROWN) and neutral (BLUE) wires only. Double insulated products are always marked with this symbol . **To re-wire, connect the brown and blue wires as indicated below. DO NOT connect the brown or blue to the earth terminal.**

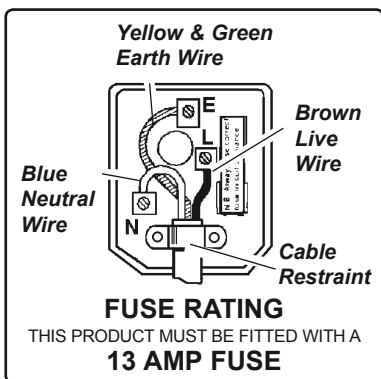

- 1.1.10. Some products require more than a 13 amp electrical supply. In such a case, NO plug will be fitted. **You must** contact a qualified electrician to ensure a 30 amp fused supply is available. We recommend you discuss the installation of an industrial round pin plug and socket with your electrician.
- 1.1.11. **Cable extension reels.** When a cable extension reel is used it should be fully unwound before connection. A cable reel with an RCD fitted is recommended since any product which is plugged into the cable reel will be protected. The section of the cores of the cable is important and should be at least 1.5mm<sup>2</sup>, but to be absolutely sure that the capacity of the cable reel is suitable for this product and for others that may be used in the other output sockets, we recommend the use of 2.5mm<sup>2</sup> section cable.

## 1.2. SAFETY AND MAINTENANCE.

- ✓ Keep the log splitter clean for best and safest performance.
- ✓ Maintain the log splitter in good condition (use an authorised service agent).
- ✓ Use a qualified person to lubricate and maintain the log splitter.
- ✗ **DO NOT** use brake fluid to top up hydraulic unit.
- ✗ **DO NOT** operate the log splitter if damaged.
- ✓ Replace or repair damaged parts. *Use genuine parts only. Unauthorised parts may be dangerous and will invalidate the warranty.*

## 1.3. WORKSHOP/ENVIRONMENTAL SAFETY.

- ✓ Locate the log splitter on dry, level and solid ground in a suitable work area with adequate lighting.
- ✓ Keep the area clean and tidy and free from unrelated materials. Do not leave tools, logs or other items lying around where they could become a tripping hazard.
- ✗ **DO NOT** operate the log splitter in wet or damp areas or expose it to rain.
- ✗ **DO NOT** operate the log splitter in areas where fumes from paint, solvents, or flammable liquids pose a potential hazard.

## 1.4. OPERATOR SAFETY.

- ✓ Remove ill fitting clothing. Remove ties, watches, rings and other loose jewellery, and contain long hair.
- ✓ Wear protective, electrically non conductive gloves .
- ✓ Always wear safety goggles. Everyday spectacles are not sufficient protection.
- ✓ Maintain correct balance and footing, do not over-reach. Ensure the floor is not slippery and wear non-slip, protective footwear.
- ✗ **DO NOT** allow untrained persons to operate the log splitter.
- ✗ **DO NOT** operate the log splitter with the guards or guides removed.
- ✗ **DO NOT** operate the log splitter when you are tired or under the influence of alcohol, drugs or intoxicating medication.
- ✗ **DO NOT** attempt to load a log until the log pusher has returned to the stop position.
- ✓ Stay alert and always pay attention to the movement of the log pusher.
- ✓ The log splitter must always be operated by one person only.
- ✓ Keep hands away from the moving parts of the log splitter.
- ✓ Keep hands away from splits and cracks which open in logs. They may close suddenly and crush or cut off parts of your hands. For this reason do not attempt to remove jammed logs by hand. A jammed log is a log which is only partially split and continues to grip the splitting wedge.

## 1.5. SAFETY OF OTHERS.

- ✗ **DO NOT** allow another person to help you with a jammed log.
- ✓ Keep children and unauthorised persons away from the work area.
- ✓ The log splitter must always be operated by one person only. Other people must keep a safe distance from the log splitter especially when it is in operation.
- ✓ Store the log splitter in a safe area away from children and other people not qualified to use the log splitter.

## 1.6. GENERAL SAFETY.

- ✗ **DO NOT** make any modifications to the log splitter.
- ✗ **DO NOT** exceed the stated log capacity of the log splitter.
- ✗ **DO NOT** use the log splitter for a task it is not designed to perform.
- ✗ **DO NOT** leave the log splitter until the splitting wedge has returned to the start position.
- ✗ **DO NOT** force the log splitter to work beyond its specified capacity.
- ✓ Ensure that there are no nails, screws or other foreign objects in logs to be split.
- ✓ The end of logs should be cut square.
- WARNING!** The warnings, cautions and instructions referred to in this manual cannot cover all possible conditions and situations that may occur. It must be understood that common sense and caution are factors which cannot be built into this product, but must be applied by the operator.

## 2. INTRODUCTION & SPECIFICATION

Safe and easy way to split logs, offering continuous sizing and up to 5.5tons of pressure. Three tier table system allows workpiece to be as near to wedge as possible minimising splitting time. Fitted with a two hand safety operation, twin pull-in and push-down levers.

<b>Model No:</b> .....	<b>LS1050V</b>
Tier Log Lengths .....	540, 790, 1050mm
Maximum Log Diameter .....	320mm
Vertical Ram Travel .....	500mm
Maximum Load Pressure .....	5.5ton
Motor Power: .....	3000W
Overall (W x L x H): .....	565 x 840 x 1520mm
Weight: .....	97kg

### 3. PRODUCT FEATURES

(Refer to fig.1 below). The log splitter has an electrically powered hydraulic ram situated inside the lower hollow upright steel section. The ram is usually fully extended at rest and is connected to the upper hollow steel section behind the splitting wedge (2). When the motor is switched on and the two control levers are operated the ram retracts and draws the splitting wedge downwards to split the log situated on the table.

- 3.1 **Serrated Log Clamp.** Grips log when pressure is applied through the control levers (24).
- 3.2 **Splitting Wedge.** After prolonged use it may be necessary to sharpen the wedge with a fine toothed file.
- 3.3 **Upper Steel Section (moving).** Drawn downwards by ram action.
- 3.4 **Adjustable Ram Travel Rod.** Controls the ram starting point above the table.
- 3.5 **Upper Transit Handle.** Used in conjunction with lower transit handle (8) when unit is moved
- 3.6 **Ram Travel Rod Locking Knob.** Locks ram travel rod when setting ram travel.
- 3.7 **Control levers connection bracket.** Transfers the action of the control levers to the hydraulic system.
- 3.8 **Lower Transit Handle.** Used in conjunction with upper transit handle (8) when unit is moved
- 3.9 **Mains Connector Shield.** Protects mains connector from ingress of dust and debris.
- 3.10 **ON Switch.** Starts electric motor.
- 3.11 **Lower Steel Section (static).** Houses the ram.
- 3.12 **Motor.** Drives pump to power hydraulic system.
- 3.13 **Pump Housing Guard.** Protects pump and hydraulic pipework.
- 3.14 **Oil Tank Cap.** Also acts as an air bleed when loosened by several turns.
- 3.15 **Wheels.** Only make contact with the ground when the unit is tipped backwards for transit.
- 3.16 **Base of unit.** Ensure that the base is on a level and firm surface to ensure stability of unit during use.
- 3.17 **Lower Table Position.** Ensure that table is fully inserted and hooked into position on each side of beam.
- 3.18 **Middle Table Position.** Ensure that table is fully inserted and hooked into position on each side of beam.
- 3.19 **Table Locking Knob.** Screw fully in to lock table in each position.
- 3.20 **Table.** Ensure that table is fully inserted and hooked into position on each side of beam.
- 3.21 **Upper Table Position.** Ensure that table is fully inserted and hooked into position on each side of beam.
- 3.22 **OFF Switch.** Stops electric motor.
- 3.23 **Serrated Log Clamp.** Grips log when pressure is applied through the control levers (24).
- 3.24 **Control levers.** Used to grip the log and initiate the ram movement.
- 3.25 **Control lever guard (Wire).** Protects hands when using control levers.
- 3.26 **Control lever shields.** Protects hands when using control levers.

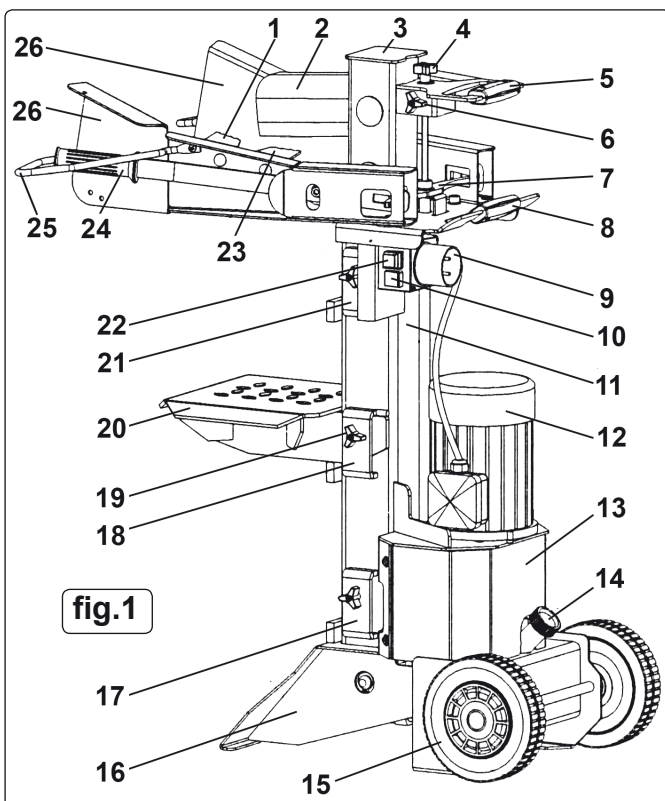

fig.1

### 4. SET UP & PREPARATION

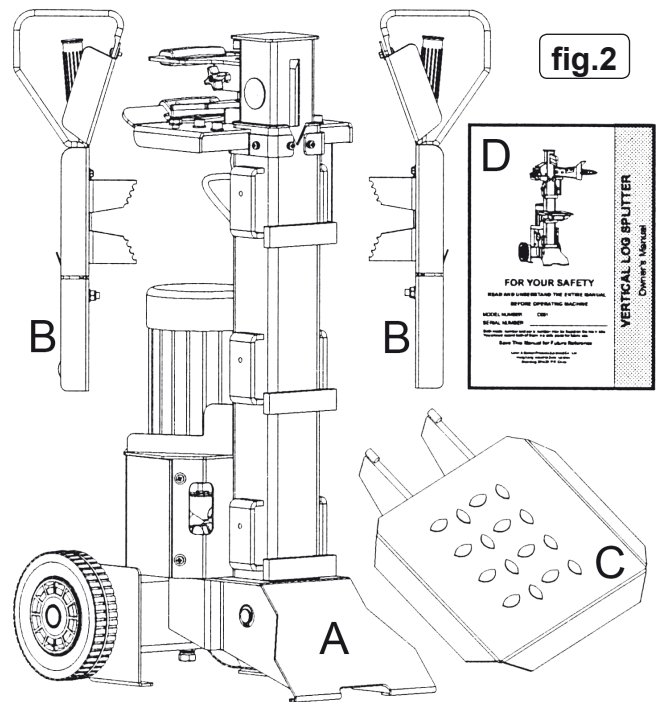

fig.2

- 4.1 **Unpacking.** Open the carton and remove the Control Lever and Guard Assemblies (Bx2), the worktable (C), and the users manual (D).
- 4.1.1 At least two people will be required to unpack the log splitter as it is very heavy. Lower the carton onto one of its sides and open it at the wheels/base end of the log splitter (if necessary reseal the end already opened).
- 4.1.2 Fold the flap next to the wheels back onto the carton and turn the carton until this flap is trapped on the ground.
- 4.1.3 Fold out the other flaps and with extra help, tip the carton into an upright position so that the log splitter is resting on its base. Ensure that the carton does not move as this is done. Lift the carton off the log splitter.

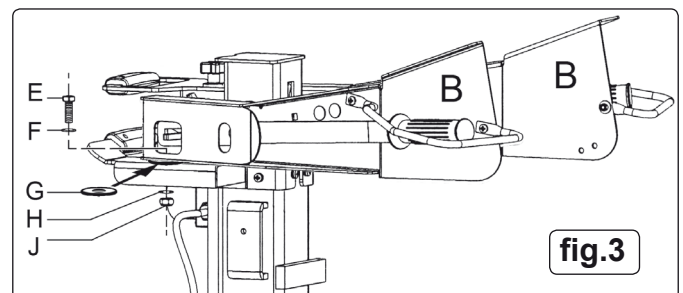

fig.3

- 4.2 **Assembly.** Bolt the Control Lever and Guard Assemblies (B) to the platform on the log splitter as shown above in fig.3 using Bolt (E), Washers (F,G & H) and nut (J).
- 4.2.1 Ensure that the ends of the Control Lever Bracket (see fig.1-7) are inserted into the slot at the end of each Control Lever before inserting the bolt.
- 4.2.2 Washer (G) should be sandwiched between each Guard Assembly and the platform as indicated in fig.3 above. Grease the upper face of washer (G) before assembly.

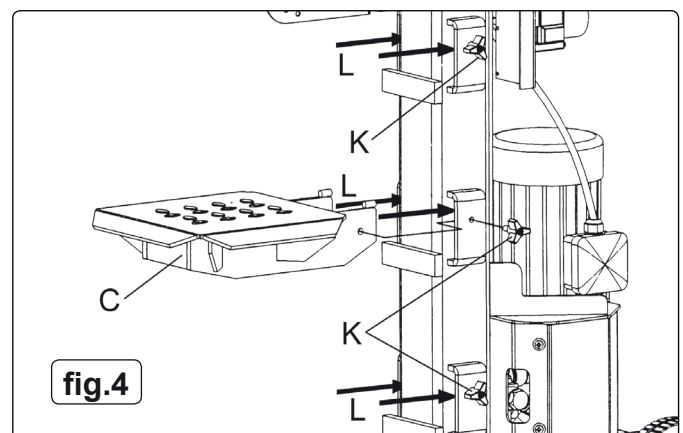
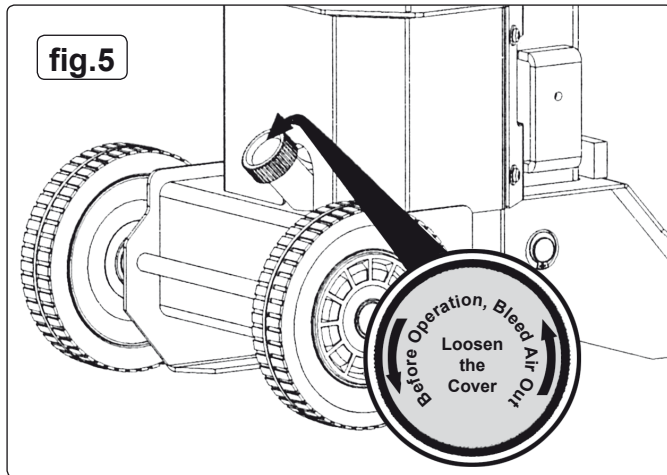

fig.4

- 4.2.3 Insert worktable (C) into one of the three sets of brackets (L) as shown in fig.4. At each position there is a locking knob (K) which should be turned clockwise so that its threaded portion passes into the hole in the table (C) thus locking it in position.



- 4.3 **Bleeding.** The filler cap on the hydraulic oil tank also acts as a means of bleeding air from the system. See fig.5 above. Before operating the log splitter the filler cap should be opened by 4 turns to allow air to pass in and out of the oil tank. Air flow through the filler cap should be detectable during operation. When moving the log splitter close the filler cap to avoid spilling oil. **Remember to open it again before the next operation.**

- WARNING! Failure to open the bleed screw will trap air within the system. The continued compression and decompression of this air will blow out the seals of the hydraulic system and cause permanent damage to the log splitter thus invalidating your warranty.**

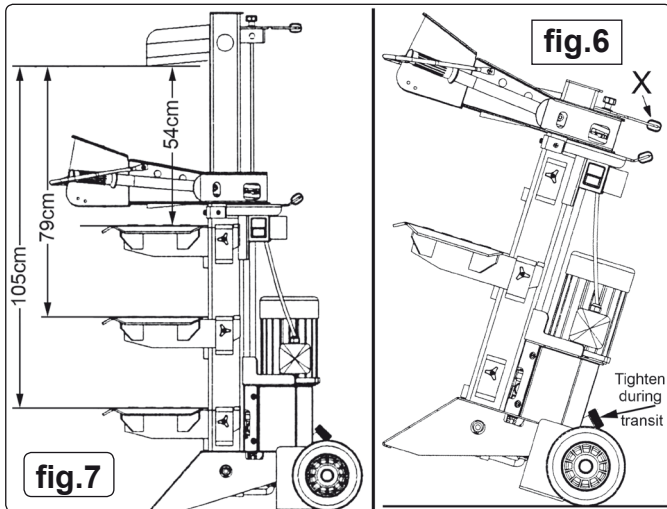

- 4.4 **Transportation.** Prior to transportation tighten the hydraulic oil tank cap to prevent spillage of oil. Tip the log splitter back onto its wheels using the handle (see 'X' in fig.6 above) to transport it short distances. Remember to loosen the cap again before operating the log splitter.
- WARNING! If using a crane to move the log splitter do not use the handle as a lifting point. If using slings they should be placed around solid items such as the hydraulic tank or the main upright steel section with due regard to the centre of gravity when the unit is lifted. Slings should not be placed under the front foot as they may damage hydraulic pipes in that area. Neither should slings be placed under the work table or under the control arms as they are not designed to support the weight of the whole machine.**

- 4.5 **Work site preparation.** Work safely and save effort by planning your work site beforehand. Have the logs positioned where they can easily be reached. Have a site located to stack the split wood or load it directly into a suitable vehicle or trailer.
- 4.5.1 When cutting up wood for splitting bear in mind the capacity of the machine for each table height being 54cm, 79cm and 105cm. Decide which table capacity is most appropriate (see fig.7) and cut the wood slightly shorter than the stated length. Insert the table into the chosen position and turn the locking knob fully clockwise to lock it.

- 4.6 **Lubrication.** To aid smooth operation and prolong the working life of the unit apply a thin coat of grease to the four surfaces of the upper moving steel section and also to the splitting wedge as indicated in fig.8 below.

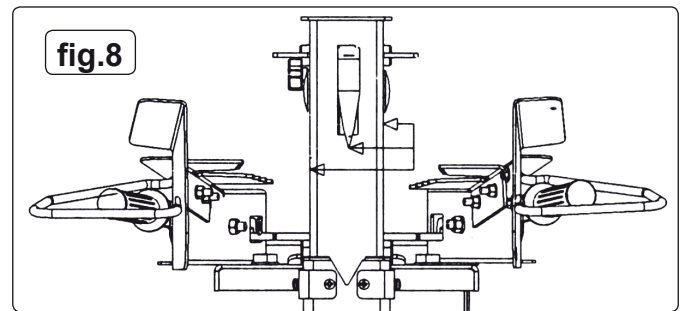

## 5. OPERATING INSTRUCTIONS

- WARNING! Ensure you read, understand and apply the safety instructions before use.**
  - WARNING! This system has been designed to prevent the operator from handling the log during the splitting process. For safety reasons the operator must not ask a second person to place or handle the log. The system is designed to be operated by one person only.**
- 5.1 Ensure that the power supply cable to the log splitter is routed so as not to be a tripping hazard or be positioned in such a way as to be prone to damage or pulling.
  - 5.2 In low temperature conditions preheat the hydraulic oil by running the motor under no load for 15 minutes prior to commencing work.
  - 5.3 Before splitting any logs you must check that the control levers are functioning properly by doing the following tests:
    - 5.3.1 Push down on both control levers. The splitting wedge should lower to approximately 50cm above the highest table position.
    - 5.3.2 If either control lever is released the splitting wedge should remain in the lowered position.
    - 5.3.3 When both levers are released the ram should rise to its highest position automatically.
  - 5.4 When many logs of approximately the same length are to be split, the ram stroke can be set to avoid having to wait for the ram to operate through it full stroke every time. See fig.9 below.

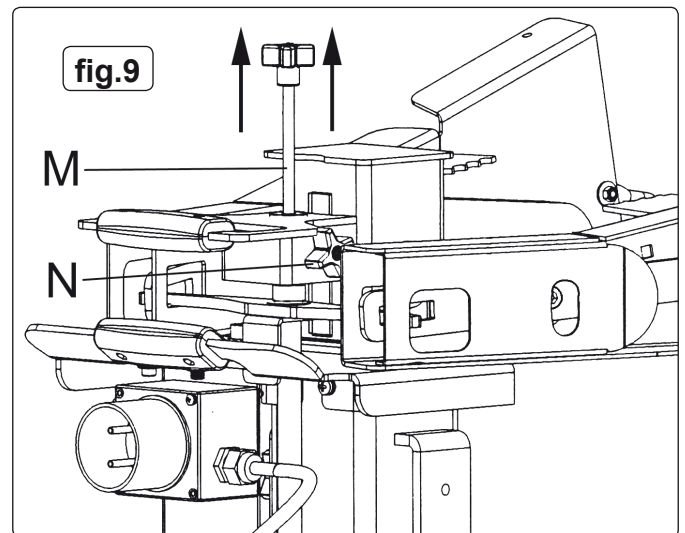

- 5.4.1 Hold down both control levers and move the splitting wedge down to the desired starting position being 3 to 5cm above the log to be split.
  - 5.4.2 Release one of the control levers and switch the motor off. The splitting wedge should remain where it is.
  - 5.4.3 Release the locking knob (N) and raise the adjusting rod (M) using the knob on its end until spring resistance is felt. Tighten the locking knob (N).
  - 5.4.4 When the motor is switched on the splitting wedge should remain in the position set.
  - 5.4.5 When both control levers are held down the splitting wedge will move down to split the log and then return to the position set when both levers are released. See also fig.10.
- WARNING! Always split a log along its grain. Never attempt to split a log laid across the machine as this could be dangerous for the operator and could seriously damage the machine.**

## 5. OPERATION CONTINUED

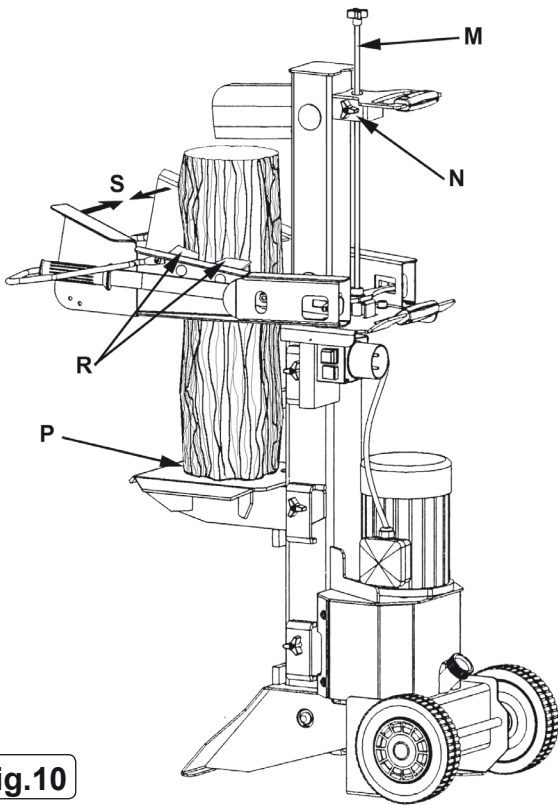

fig.10

- 5.4.6 Always place log on the highest feasible table position to ensure the maximum stroke of the splitting wedge through the lodge.
- 5.4.7 Place log onto the support table ensuring that it is vertical and sitting flat on the table as shown above at (P) in fig.10. It is essential that the wedge and support table will contact the log square on. **Never attempt to split a log if it is sitting at an angle.**
- 5.4.8 Take hold of the control handles and move the guard assemblies inwards (see 'S' in fig.10 above) until the serrated log clamps (R) make contact with the log. Do not press the control handles down until the log is firmly gripped as shown below in fig.11.
- 5.4.9 Push the control levers down to start the splitting. Releasing either lever stops the motion of the splitting wedge. When both handles are released the wedge returns to the start position.

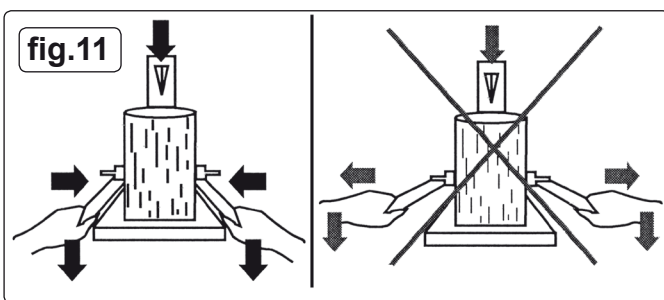
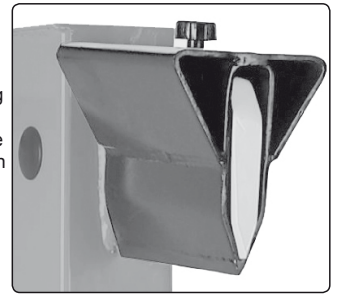

fig.11

- 5.4.10 Stack as you work to keep the work area hazard free. Clean up accumulated wood chips and other debris to keep the work area safe.
- 5.4.11 When work is finished allow the splitting wedge to return to the rest position and switch OFF the splitter and unplug it from the mains supply.
- 5.4.12 Clean the log splitter and tidy the work area ready for the next work session.

### 5.5 Obtuse Wedge

When longer logs are not fully split, the obtuse wedge can be fitted to assist the splitting process as shown on the right. The obtuse wedge slides over the main splitting wedge and is held in place by tightening the knob on the top. The two stage wedge forces the splitting pieces further apart to achieve a fully split log.



## 6. MAINTENANCE

- 6.1 **Checking the oil.** Check the oil level regularly as low oil levels can damage the pump. **Sealey hydraulic oil is available in 500ml containers (Part no: HJO500MLS) or 5ltr containers (Part no: HJO5LS).**
- 6.1.3 Ensure the log splitter is disconnected from the mains power supply.
- 6.1.4 Ensure that no dirt or debris enters the oil tank.
- 6.1.5 Unscrew the oil filler cap which has a dipstick attached to it. The oil should reach the top of the flattened portion of the dipstick which is equivalent to the oil being 1 to 2cm lower than the upper surface of the tank.
- 6.1.6 The oil should be completely changed once a year.
- 6.1.7 Following an oil change the log splitter should be operated a few times without actually splitting.
- 6.1.8 The old oil should be responsibly recycled according to local authority regulations.
- 6.2 **Sharpening the wedge.** After prolonged use the splitting wedge may become dulled. When required sharpen using a fine toothed file.

## 7. TROUBLESHOOTING

SYMPTOM	POSSIBLE CAUSE	SOLUTION
Motor does not start.	No current present	Check main fuse
	Extension cable defective	Unplug, check and /or replace
	Switch or capacitor defective.	Contact service agent and/or electrician
Incorrect motor rotation	Incorrect connection	Contact service agent and/or electrician
Motor is running but log splitter does not work	Valve not opening due to loosening of mechanism	Check and tighten parts
	Control levers or connection parts bent	Repair/replace bent parts
	Hydraulic oil level low	Top up oil level
Abnormal vibration and noise when log splitter is working	Hydraulic oil level low	Top up oil level

### IMPORTANT: NO RESPONSIBILITY IS ACCEPTED FOR INCORRECT USE OF THIS PRODUCT.

Hydraulic products are only repaired by local service agents. We have service/repair agents in all parts of the UK.

**DO NOT RETURN THE PRODUCT TO US.** Please telephone us on 01284 757500 to obtain the address and phone number of your local agent. If product is under guarantee please contact your dealer. **DE-COMMISSIONING PRODUCT** Should the product become completely unserviceable and require disposal, draw off the oil into an approved container and dispose of the product and the oil according to local regulations.

**NOTE:** It is our policy to continually improve products and as such we reserve the right to alter data, specifications and component parts without prior notice.

**IMPORTANT:** No liability is accepted for incorrect use of this product.

**WARRANTY:** Guarantee is 12 months from purchase date, proof of which will be required for any claim.

**INFORMATION:** For a copy of our latest catalogue and promotions call us on 01284 757525 and leave your full name and address, including postcode.



Sole UK Distributor, Sealey Group,  
Kempson Way, Suffolk Business Park,  
Bury St. Edmunds, Suffolk,  
IP32 7AR

01284 757500

www.sealey.co.uk

01284 703534

sales@sealey.co.uk